



Go further

The team at The Ridgeline Hotel Estes Park® specializes in group events. You've found a site that will thrill every member of your group – with the dual delights of Rocky Mountain National Park and downtown Estes Park.

RidgelineHotel.com | 970.527.1500

101 South Saint Vrain Avenue, Estes Park, CO 80517



A breathtaking backdrop

Rocky Mountain National Park, one of the most visited national parks in the United States, was established in 1915 after a massive national lobbying campaign by Enos Mills. The naturalist and lodge owner played a huge role in creating the park and subsequently the Estes Park, Colorado area. Visitors from all over the world come to marvel at the magnificent Rockies.

If you're lucky enough to spend some time in the Rocky Mountain region, The Ridgeline is equipped with all the services and amenities of a full-service hotel, and attaches directly to the Estes Park Conference Center for ease of access to both hotel guestrooms and meeting spaces.

The unique property, nestled at the base of Rocky Mountain National Park and just a few

minutes from downtown Estes Park, blends a casual style with modern amenities and design in a laidback mountain atmosphere.

Few things are more inspiring than being surrounded by the beauty of the mountains. The Ridgeline offers a peaceful refuge amid stunning natural beauty, where creative ideas thrive.

Many distinctive experiences both on the property and in the national park are available. Team-building activities such as golf tournaments, mountain survival challenges and more can take your group experience to the next level.

With features like numerous meeting venues, flexible meeting facilities and state-of-the-art audio/visual equipment, The Ridgeline Hotel Estes Park® is the perfect home base for your group.



We've thought about every aspect of 2021 group events, so you don't have to. As such, Delaware North's Rest Assured: Commitment to Care is a comprehensive program to help keep guests and employees safe and slow the spread of COVID-19.

We've reengineered our operating procedures to minimize contact risk and bolstered hygiene protocols to exceed best practice guidelines of the U.S. Centers for Disease Control and Prevention (CDC). Our facilities undergo rigorous, ongoing deep cleaning and disinfection.

As we all navigate the pandemic, we recognize that making travel decisions may leave us feeling somewhat uneasy. We want our guests to "Rest Assured" that we have them covered. Our relaxed cancellation policy provides guests with the confidence of flexibility. Under our policy, reservations will be allowed to be changed or canceled at no charge up to 48 hours before the scheduled arrival date. Changes to the reservation will be subject to availability and any rate differences.

At The Ridgeline Hotel Estes Park® and each of our properties, count on group events engineered with an abundance of caution.



Meeting and exceeding expectations

The Ridgeline Hotel Estes Park®, you'll discover one of the world's most unique landscapes while relaxing in picture-perfect surroundings. The Rocky Mountain region offers an ideal setting for conferences, seminars, retreats and more. Whatever the size, we can help you create an elevated, exciting experience.

The Ridgeline delivers 20,000 square feet of venue space, 147 upscale guestrooms and suites and unforgettable group activities. Our talented team will work hand in hand with you to customize a meeting experience that will delight each member of your group.

Easily accessible from Denver and Boulder and just steps from Rocky Mountain National Park, The Ridgeline can help make your next retreat your best one yet.

The Ridgeline is a winning destination for your group:

- Minutes from downtown Estes Park
- Just over an hour's drive from the Denver metro area
- Over 20,000 square feet of indoor and outdoor space
- 8,000 square foot Grand Ballroom
- 5,600 square foot Aspen Courtyard
- Full-service catering options
- Custom meeting experiences
- Group activities including guided hikes, golf tournaments and more
- Game room lounge and bar
- 147 guestrooms and suites



Our talented team will work hand in hand with you to customize a meeting experience that will delight each member of your group.



The best of Estes Park

Every day is extraordinary at The Ridgeline, a Rocky Mountain resort with an ideal location. The Ridgeline Hotel Estes Park is centrally located so guests can go exploring as soon as they leave the hotel. Steps away from downtown Estes Park and near the gateway to Rocky Mountain National Park, The Ridgeline gives our guests access to infinite adventures.

On-site recreational activities

- Indoor saltwater pool/hot tub with 180-inch projector TV screen
- Fire pits with s'mores kits
- Game room lounge and bar with pool table, air hockey, foosball, Xbox gaming, giant Jenga and more
- Fitness room
- Bicycle rentals included

Downtown Estes Park

Estes Park is a four-season destination that's been drawing visitors for more than 100 years. Widely regarded as the gateway to Rocky Mountain National Park, Estes Park is a destination for thrill-seekers, casual vacationers and everyone in between.

Our staff can provide more information on any activities Estes Park has to offer to help make your conference, meeting or event even more memorable.

Activities include:

- Downtown Estes Park Riverwalk
- Nature walks/hiking/boating
- Golf
- Jeep tours

- Miniature golf
- Fly fishing
- Horseback riding
- Rock climbing
- Mountain biking
- Bird/wildlife watching
- Whitewater rafting
- Cross-country skiing
- Snowshoeing
- Shopping
- Spa services
- Open Air Adventure Park

A visit to Estes Park stays with you long after you depart.

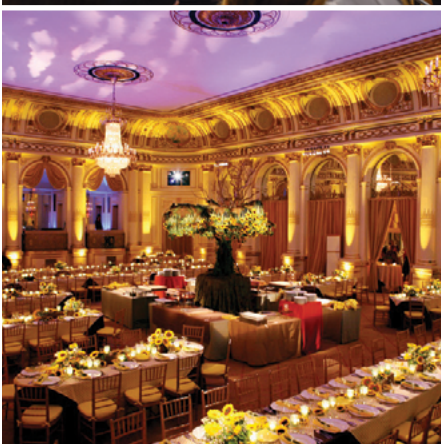

Amazing experiences

From providing a dining experience amid the splendor of the Grand Canyon, to serving fans and players at the Australian Open, to catering the Emmy Awards Governors Ball – we're there. Delaware North services more than 200 locations on four continents, serving 500 million guests each year. We manage food and beverage concessions, premium dining, street side restaurants, retail stores, hotels, resorts, specialty lodging, casino gaming and recreation services.

From executive retreats and incentive trips to team-building activities and conferences, Delaware North has you covered. We are your go-to partner for memories that will last a lifetime.

Luxurious accommodations

Delaware North's portfolio of luxury resorts provide guests with world-class hospitality, the best local cuisine and amenities such as spas that complement the natural beauty of the locations. Among many wondrous locations, we own and operate Lizard Island Resort on Australia's Great Barrier Reef and Tenaya Lodge at Yosemite in California.

Connect with nature

Connect with nature We have adventure awaiting around every corner, including popular National Parks at Yellowstone, the Grand Canyon, Sequoia and Kings Canyon,

Glacier and Shenandoah, along with Niagara Falls State Park.

Out of this world

Among our flagship locations for events is Kennedy Space Center Visitor Complex, which we operate on behalf of NASA. We can accommodate groups of 10 to 5,000, with offerings that include dining under Space Shuttle Atlantis, receptions next to the actual Lunar Rover and opportunities to dine with astronauts.

Time to dine

Patina Restaurant Group – a wholly owned subsidiary of Delaware North – is a leader in the premium segment of the restaurant and catering industry. Our operations locations include restaurants from Los Angeles to New York, Walt Disney World® and Disneyland®. We are also the catering team behind The Plaza Hotel in New York City.

The thrill of the game

Delaware North operates food, beverage and retail services at more than 50 professional sports and entertainment venues around the world, including MetLife Stadium near New York City, Wembley Stadium in London and Lambeau Field in Green Bay. We own and operate TD Garden, home of the NHL's Boston Bruins (owned by our chairman, Jeremy Jacobs) and the NBA's Boston Celtics.

Top to bottom:

Patina Catering at the MTV Movie & TV Awards; Kennedy Space Center Visitor Complex; The Hub on Causeway & TD Garden; The Plaza Hotel

The group event specialists

ROOM	SETUP CAPACITIES						
	Theater	Classroom	U-Shape	Crescent Rounds	Rounds	Hollow Square	Reception
Grand Ballroom	650	400	—	320	400	—	700
Salon: A, B, C, D, E, F	90	60	30	48	60	40	90
Salon: ABC, DEF	325	180	—	144	200	—	350
Salon: AB, BC, DE, EF	180	130	58	104	130	76	180
Salon: AF, BE, CD	180	130	—	104	130	—	180
Junior Ballroom	180	130	58	104	130	76	180
Lake Estes	60	36	20	24	30	30	50
Trail Ridge	160	90	45	72	90	60	160
Lumpy Ridge Room	80	45	42	40	50	48	80

ROOM	DIMENSIONS (L X W X H)	SQ FT
Grand Ballroom	100' x 80' x 14'	8,000
Salon A	43' x 26' x 14'	1,118
Salon B	41' x 26' x 14'	1,066
Salon C	43' x 26' x 14'	1,118
Adjustable Corridor	14' x 80' x 14'	1,120
Salon D	43' x 26' x 14'	1,118
Salon E	43' x 26' x 14'	1,118
Salon F	43' x 26' x 14'	1,118
Pre-Function Space	Varied	5,000+
Junior Ballroom	39' x 62' x 9'	2,330
Trail Ridge	39' x 40' x 9'	1,560
Lake Estes	35' x 22' x 9'	770
Lumpy Ridge Room	24' x 40' x 9'	1037
Aspen Courtyard	70' x 80' x NA	5,600

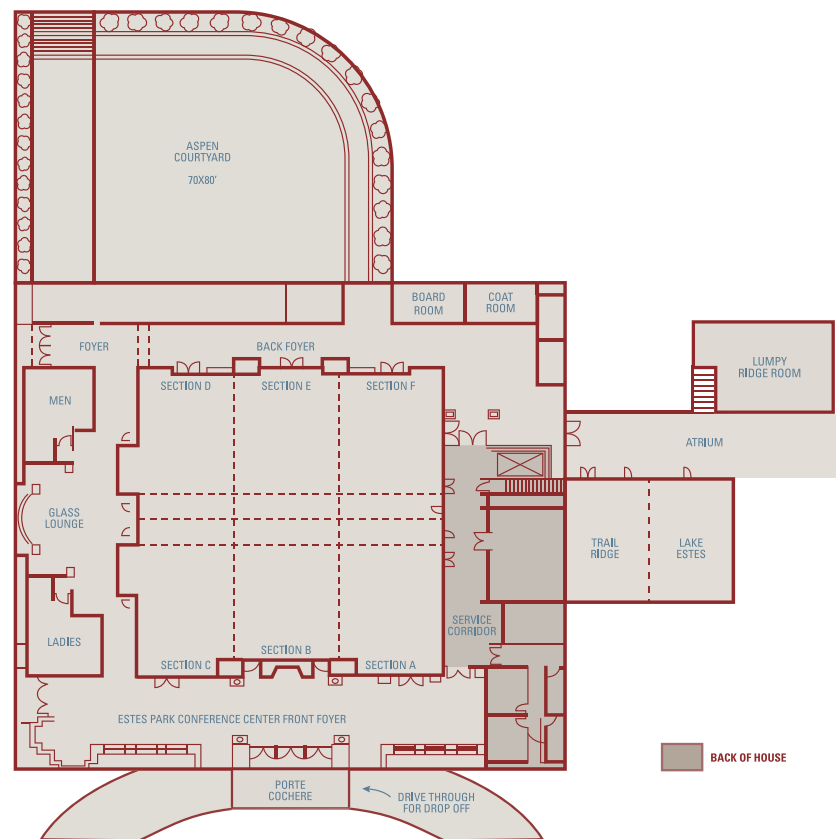

With newly renovated guest rooms and 11 flexible meeting rooms including an 8,000-square-foot ballroom, you can take your corporate retreat to new heights at The Ridgeline. Our team will customize a meeting experience that suits your exact needs. Let us help you create an experience that your group won't soon forget.

Out here, inspiration is all around you. To learn more, call our sales team at 970-527-1500 or visit RidgelineHotel.com.